

## Aqualift S Compact lift stat. Tronic, GTF1200 res., Floor slab, tile.

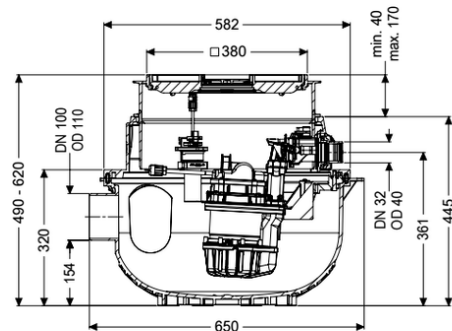

### Article information

Item no.: 281250XC  
GTIN: 4026092093726  
Price group: 20

### Advantages

- Space-saving due to installation in floor slab with integrated drainage function
- Easy retrofitting from Mono to Duo possible
- Quiet operation, as the pump installation does not cause any structure-borne sound emissions.

### Description

The ready to plug in lifting station for faecal-free wastewater is equipped with one or two submersible pumps and a backflow preventer. The collection tank made of permanently resistant polymer (PE) has an open pump tank. One-handed closures enable easy removal of the integrated components. The system for installation in the floor slab is preassembled for final installation on site.

Variant

Type of system:

Resistant:

Single unit

Resistant to saline media, wastewater from water softening systems and wastewater containing condensate from heating systems

Rim width:

Backwater protection:

Control unit

integrated

General characteristics

Colour:

Standard:

Type of wastewater:

Installation situation:

Delivery state:

black

EN 12050-2

without sewage

floor slab installation

Installation-ready (connection parts must be connected on site)

System type:

Tronic

## Dimensions

|  |                                     |
|--|-------------------------------------|
| Net weight:  | 17,82 kg                            |
| Gross weight:  | 19,32 kg                            |
| Groundwater resistant from lower edge of base section: | 3000 mm                             |
| Installation depth:                                    | 490 - 620 mm                        |
| Vertical adjustment:                                   | vertically adjustable upper section |
| Length:  | 617 mm                              |
| Width:   | 585 mm                              |
| Packaging dimension:                                   | length                              |
| Packaging dimension:                                   | width                               |
| Packaging dimension:                                   | height                              |

## Tank/drain body

|                                |        |
|--------------------------------|--------|
| Pressure pipe connection (DN): | 32     |
| Pressure pipe connection (OD): | 40 mm  |
| Inlet nominal size (DN):       | 100 mm |
| Pumping volume:                | 20 l   |
| Tank volume:                   | 65 l   |

## Coverage features

|                       |                      |
|-----------------------|----------------------|
| Type of cover:        | tileable cover plate |
| Cover material:       | Polymer              |
| Colour of cover:      | silver grey          |
| Width of cover:       | 366 mm               |
| Length of cover:      | 366 mm               |
| Drainage function:    | yes                  |
| Cover locking:        | Lock & Lift          |
| Load class:           | K 3 (EN 1253-1)      |
| Max. flooring height: | 16 mm                |

## Pumping device

|  |                    |
|--|--------------------|
| Pump control:                                      | GTF 1200 resistant |
| Number of pumps:                                   | 1                  |
| Weight:  | 10 kg              |
| Connection type:                                   | coded plug         |
| Rated current:                                     | 6,2 A              |
| Length of mains cable for pump:                    | 5 m                |
| Self-diagnosis system (SDS):                       | I                  |
| Insulation class:                                  | F                  |
| Protection class control unit:                     | IP 68 (3m)         |
| Max. temperature (permanent) of conveyed material: | 40 °C              |
| Hot water resistance for a short time (2 min):     | 80 °C              |
| Max. pumping capacity:                             | 15,5 m³/h          |
| Max. pumping height:                               | 9 m                |
| Speed:   | 2650 U/min         |
| Power P1:  | 1,4 kW             |
| Power P2:  | 0,84 kW            |

|  |                                |
|--|--------------------------------|
| Operating mode:                                | S1                             |
| Type of fuse required (electrical protection): | C 16 A                         |
| Type of pump connection cable:                 | H07RN-F 3G 1.5 mm <sup>2</sup> |
| Impeller type:                                 | Multi-vane impeller            |
| Free passage:                                  | 30 mm                          |
| Control  |                                |
| Control unit:                                  | Comfort                        |
| Control unit function:                         | With alarm message             |
| Motor protection switch:                       | yes                            |
| Alarm sensor:                                  | optical probe                  |
| Level measurement instrument:                  | Immersion pipe                 |
| Type of level measurement:                     | pneumatic                      |
| Protection class probe:                        | IP 54                          |
| Mains frequency:                               | 50 Hz                          |
| Operating voltage:                             | 230 V                          |
| Connection type:                               | coded plug                     |
| Length of mains cable for control unit:        | 1,4 m                          |
| Potential-free contact:                        | optional                       |
| GSM interface:                                 | yes                            |
| USB interface:                                 | yes                            |
| Log book function:                             | yes                            |
| Multi-line display:                            | yes                            |
| Battery buffering:                             | yes                            |
| Self-diagnosis system (SDS):                   | yes                            |
| Warning equipment version:                     | acoustic and optical signal    |
| Rated current:                                 | 6,2 A                          |